

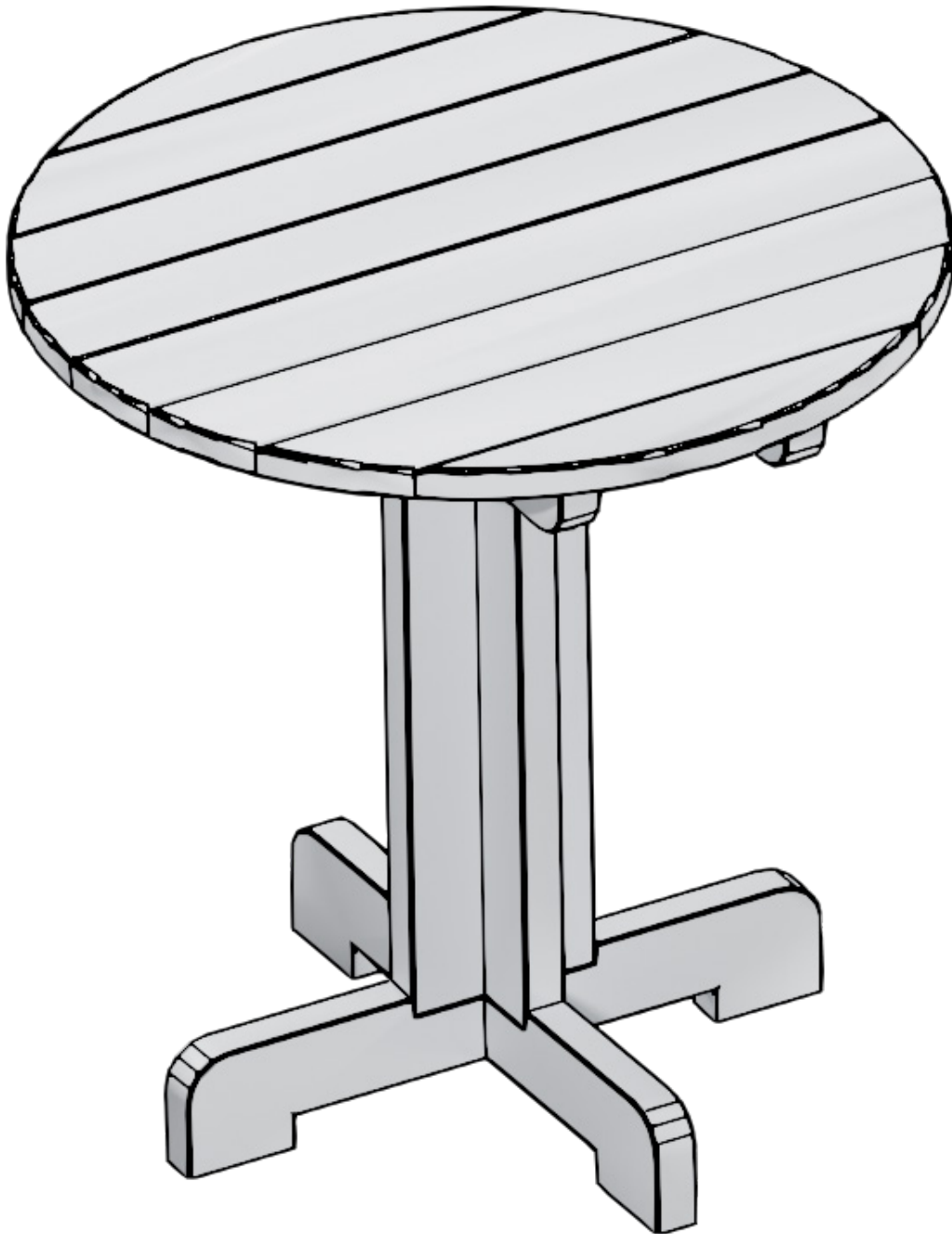

KAILUA - Low Table Assembly Instructions

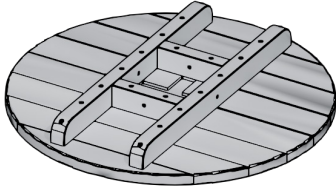

PARTS



Top
Assembly x1

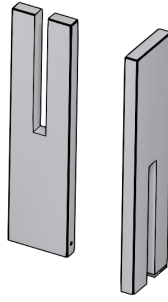

Center
Post x2

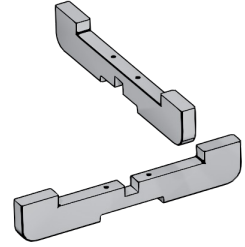

Legs x2

HARDWARE



2.1/2" Polybuster x8

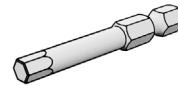

Square Drive Bit

TOOLS REQUIRED

- Impact Driver or Drill

Cleaning Tips



General Cleaning

- Wipe with soap and water solution using a soft sponge or plastic-bristled brush.
- You can use a soft-bristled toothbrush to clean spaces that are hard to reach.

Deep Cleaning

- A pressure washer can be used on the lightest setting to deep clean your furniture.
- It is not recommended to use more than 1,500psi.
- Keep the tip of the pressure washer at least 10-12 inches away from the furniture so it does not damage the lumber.

1

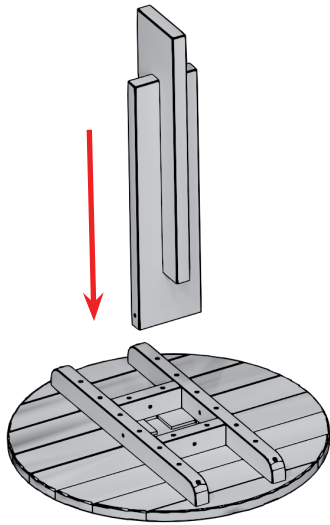

- Locate the Top Assembly and place face down as shown above.
- Locate the two Center Posts and slot together.
- Place Center Post assembly into cross groove area within the Top Assembly.

2

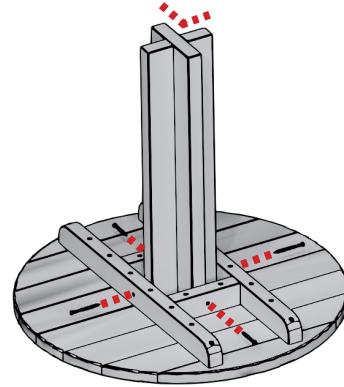

- Ensure Center Post Assembly is pressed tightly down against Top Assembly.
- Attach Center Post Assembly to Top Assembly using (4) 2.1/2" Polybusters. One from each side through pre-drilled holes as shown above.

3

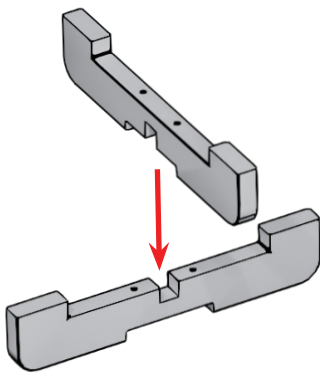

- Locate the two Leg pieces and place together as shown above.

4

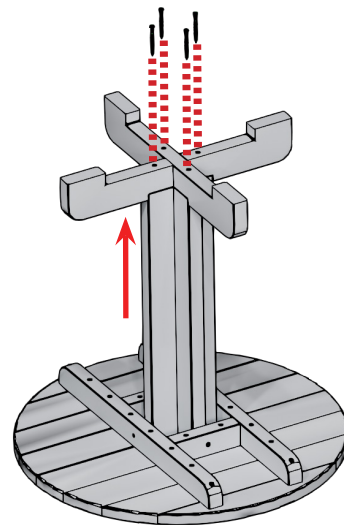

- Place the Leg Assembly on top of the Post Assembly and ensure a tight fit.
- Attach Leg Assembly to the Center Post Assembly using (4) 2.1/2" Polybusters. One through each pre-drilled hole as shown above. Ensure no gaps open between sections when tightening.

CONTACT US

230 OLD WEST PENN AVENUE
ROBESONIA, PA 19551
(800) 233-3186
GFXCUSTOMERSERVICE@GROSFILLEX.COM

SEE OUR FULL COLLECTION

WWW.GROSFILLEXFURNITURE.COM

