

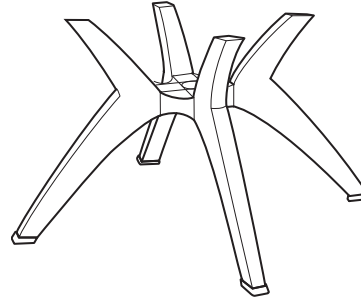

View Product



Height: 25.6"
 Width: 28.9"
 Depth: 28.9"
 Floor to brace: 12.64"
 Unit Weight: 7.3 lbs

Y-Leg Pedestal Base

Product Specifications

Product Description	Reference Number	Color	UPC Code 014306	Pack Weight Each (lbs.)	Master Pack	Master Pack Volume (cu. ft)
Y-Leg Pedestal Base	US850004	White	117829	13.00	1	2.32
	US850037	Bronze	128115	13.00	1	2.32
	US850002	Charcoal	118611	13.00	1	2.32
	US850181	French Taupe	933139	13.00	1	2.32

Features & Benefits Warranty: 2 Yrs.

- Elegant tulip base design.
- Specifically made for 42" & 48" round pool side tables in hospitality settings.
- Made of 100% prime resin, a material impervious to moisture, salt air, chlorine and most common stains.
- 40" base span for extra stability.
- Umbrella hole fits all Grosfillex 1 1/2" umbrella poles.
- Specifically designed to allow the use of Grosfillex 35 lb. table umbrella base with optional 35 lb. base ring, or the resin umbrella base with filling cap.
- Plastic brackets and hardware pack for assembly with molded melamine table tops.
- Complete tables can be custom designed by mixing this base in any of the available table top colors.
- Easy to assemble.
- Clearance of 12.64" from floor to the bottom brace.
- 1 adjustable footpad included. Additional adjustable footpads are sold separately.

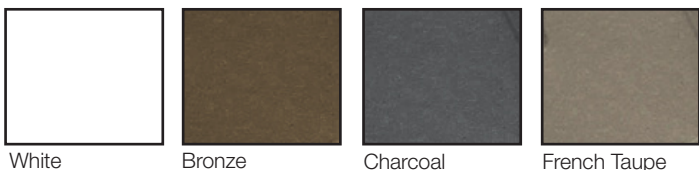

Y-Leg Pedestal Base

Spare Parts

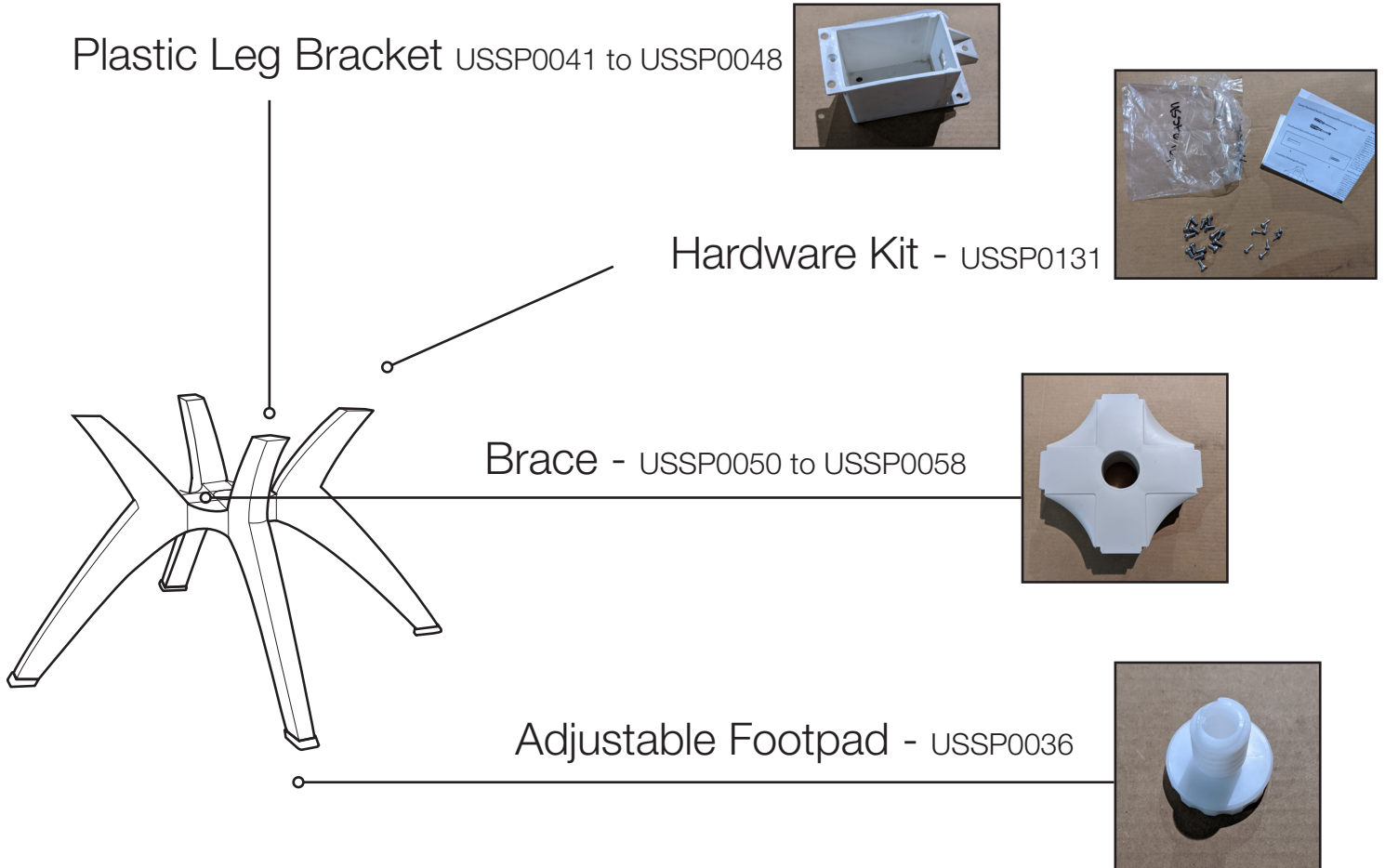

Reference	Description
USSP0041	PLASTIC LEG BRACKET CHARCOAL
USSP0042	PLASTIC LEG BRACKET WHITE
USSP0044	PLASTIC LEG BRACKET WOOD
USSP0045	PLASTIC LEG BRACKET BRONZE
USSP0046	PLASTIC LEG BRACKET SANDSTONE
USSP0048	PLASTIC LEG BRACKET AMAZGREEN
USSP0050	BRACE Y-LEG CHARCOAL
USSP0051	BRACE Y-LEG TAUPE
USSP0052	BRACE Y-LEG WHITE
USSP0054	BRACE Y-LEG WOOD
USSP0055	BRACE Y-LEG BRONZE
USSP0056	BRACE Y-LEG SANDSTONE
USSP0058	BRACE Y-LEG AMGRN
USSP0036	FOOTPAD TABLE ADJUSTABLE
USSP0131	HARDWARE KIT Y-LEG

